

C-141-245  
Timothy Matlack.

Saml Nicholas  
I-293

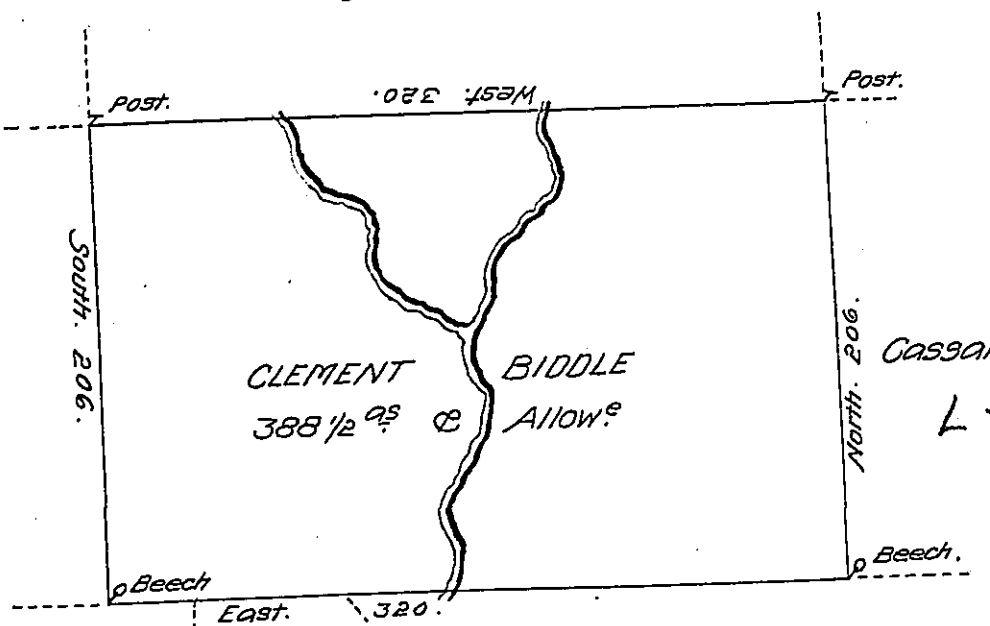

Cassandra Jacobs.  
L-70

Mary Jenkins  
D-39-149

Mathew Mc Connell.  
D-30-207

Draught of a tract of land Called \_\_\_\_\_ Situate on the Waters of Wyolusing  
 Creek Joining Land Surv.<sup>d</sup> for Saml Nicholas and others in Luzern (formerly North<sup>d</sup>)  
 County Containing three Hundred and Eighty Eight acres obl. Allow<sup>e</sup> of Six P. Cent  
 for Roads &c. Surv.<sup>d</sup> the 27<sup>th</sup> Day of August 1787 for Clement Biddle in pursuance  
 of a Warrant Dated the 27<sup>th</sup> Day of July 1787. by  
 To John Luters Esq<sup>r</sup> } W<sup>th</sup> Gray. D.S.  
 Surv.<sup>r</sup> Gen! }

IN TESTIMONY that the above is a copy of the original remaining on file in  
 the Department of Internal Affairs of Pennsylvania, made  
 conformably to an Act of Assembly approved the 16th day of  
 February, 1833, I have hereunto set my Hand and caused  
 the Seal of said Department to be affixed at Harrisburg,  
 this twenty fifth day of February 1908.

*Henry Howell*  
 Secretary of Internal Affairs.